

Arc
Club armchair,
by Kettal Studio

kettal

Club armchair

Designer
Kettal Studio

Collection
Arc

Reference
KSA500200

1/2

The Arc collection features an enveloping backrest based on fundamental geometry: a constant radius arc. It shows restrained, elegant proportions. The light aluminium frame clearly expresses a desire to maintain armchair tradition.

The backrest features simple yet sophisticated braided strips, while the seat is padded with polyurethane foam covered in matching fabric and the fabric cushion has a removable cover.

The collection is used mostly in hotels, in lobbies and rooms, on cruise ships and also in domestic settings as light furniture in sofa and dining areas.

cm/inch

78,5/30,8

48,7/19,1

42,7/16,8

cm/inch

55,4/21,8

60,7/23,9

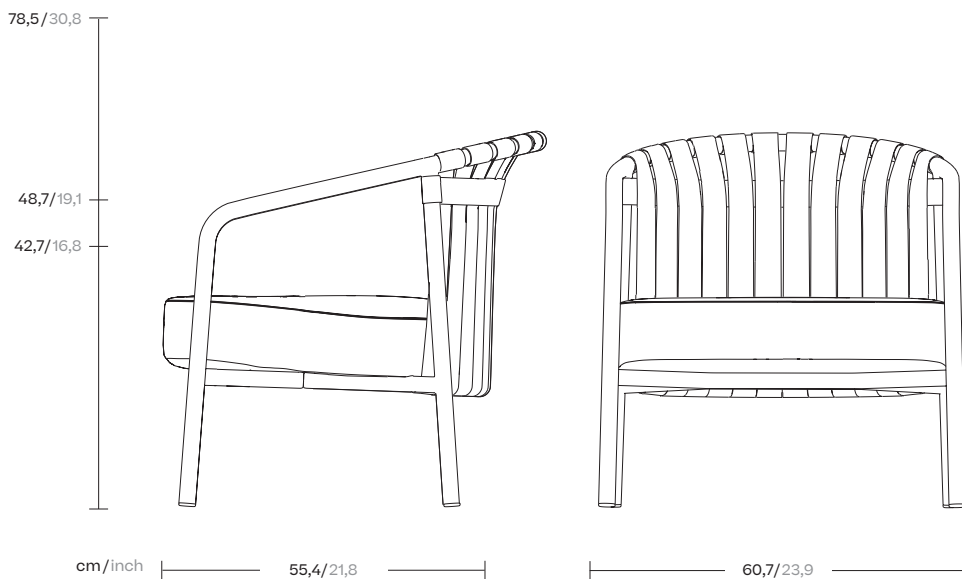

kettal

Club armchair

Designer
Kettal Studio

Collection
Arc

Reference
KSA500200

2/2

Maintenance

Clean with mild soap using a sponge or cloth. Be gentle during the cleaning process; avoid aggressive scrubbing of the fabric. After cleaning, ensure you remove any excess soap.

For stubborn stains, use diluted household bleach. Act promptly to clean stains; the longer they linger, the more challenging they become to remove.

After cleaning, steam iron the fabric using only steam. Be cautious not to place the iron directly on the fabric, as it may cause damage.

Finishes

[Click here](#) or scan the following QR code.

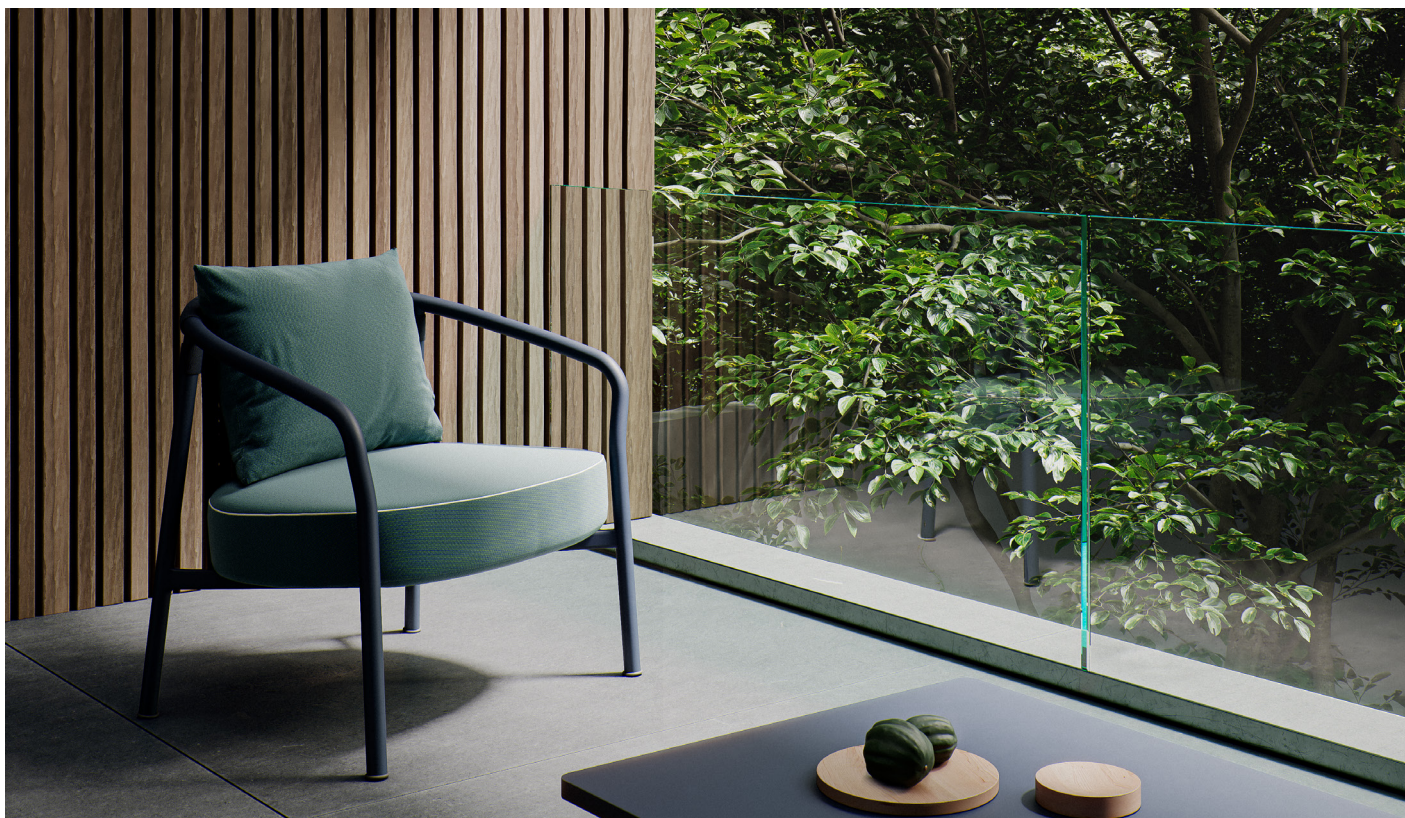

kettal