

Mia,
Floor lamp L
Battery
Assembly instructions

kettal

Mia floor lamp L Battery

Description

The lamp is built around an acid-treated glass diffuser which is protected by a large polypropylene lampshade. Both are held in place by a clever wire structure. One of Kettal wishes was to have the lamps completely waterproof, which was achieved – allowing for a wide range of applications and making it suitable for outdoor use.

cm/inch

126/49,73

Ø26,5/10,46

cm/inch

Ø43,7/17,2

Ø34,5/13,5



Information

Warning

If the wire or flexible cord is damaged, it must only be changed by the manufacturer, their Service Dept. or qualified personnel in order to avoid risk.

Cleaning Instructions

Use a soft damp cloth, with soap or neutral detergent.
Do not use alcohol or other solvents.

This symbol on the product or its packaging indicates that it must not be treated as household waste. It should, in fact, be handed in at a recognised collection point for recycling electrical and electronic equipment. For more detailed information about the recycling of this product, please contact your local city office, your household waste disposal service or the shop where you purchased the product.

LED 2,5W 3000K 300lm (included)
Mini USB connector (included)
Touch Continuous Dimmer

Battery

5 - 6 hours at maximum intensity
10 hours at minimum intensity

Battery charging time

4 - 4.30 hours

Charger recommended

Input 100-240V ~ 50/60Hz 0.2A
Output 5V --- 1A



RoHS



Switch On / Off

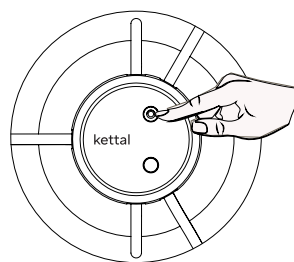
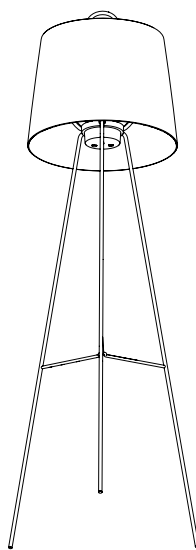
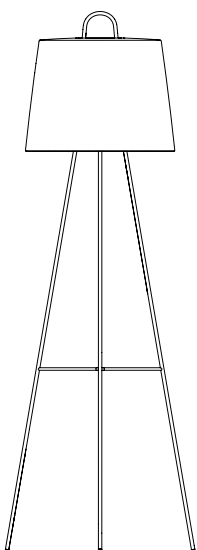

Keep your finger on the button for a few seconds to dim the light.

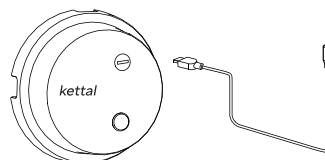
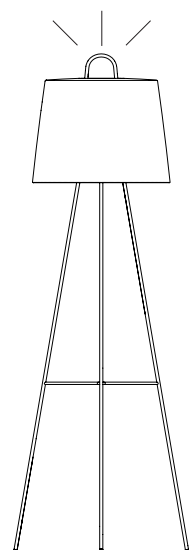

Charge

Mia floor lamp L Battery



Warning! Disconnect power supply before installation. Hold the base to unscrew it from the glass globe.

1

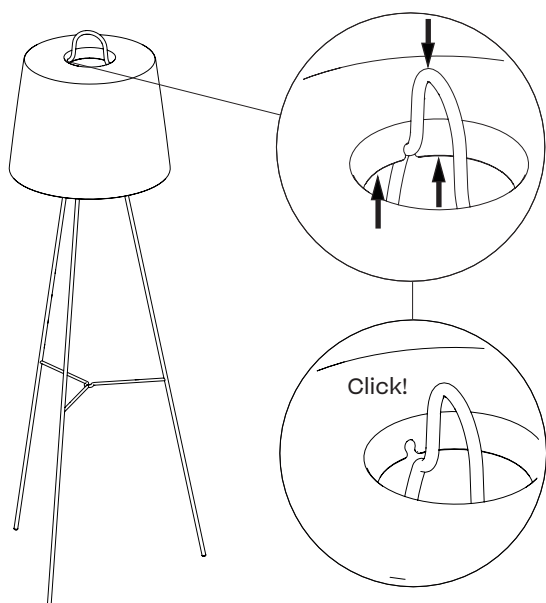

2

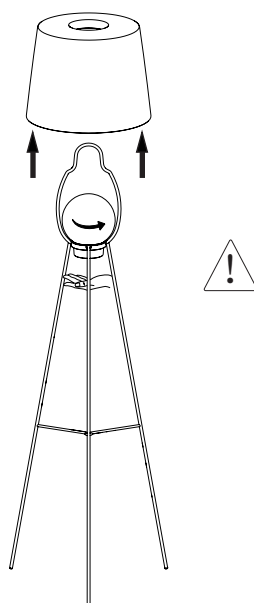

5

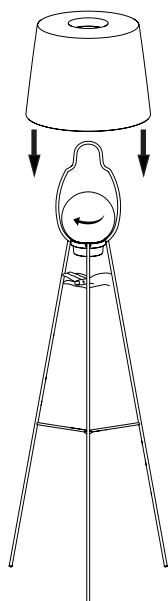

6

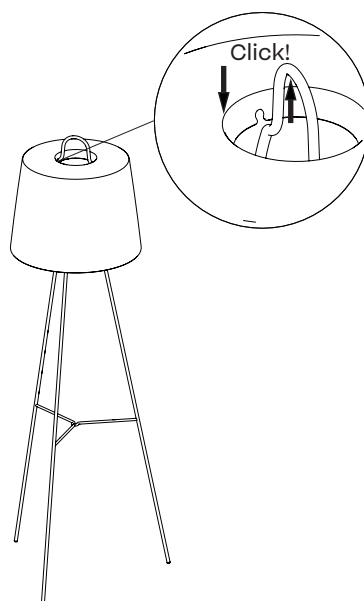

Designer
Michel Charlot

Collection
Objects

Reference
KS5700800

3

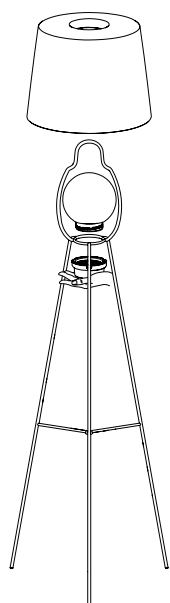

4

